

RF I Board End Connector

Electrical spec.:

•Frequency Band	DC~6GHz
•Impedance	50 Ω (Nominal)
•Dielectric Resistance	500 M Ω
•Rated Voltage	60V AC
•Dielectric Withstand Voltage	200V AC 1Min
•Contact Resistance	
Signal Contact	Initial: 20m Ω (max)
Ground Contact	Initial: 20m Ω (max)

Anray211670300JC03



Mechanical spec.:

•Signal contact	Copper Alloy(Plating Au)
•Insulator	Thermoliastic
•Ground contact	Copper Alloy(Plating Au)
•Mounted type	SMT
•Operate Temperature	-40° C~+90° C
•Operate Humidity	90%(max)
•ROHS	Compliant

VSWR

$\leq 3\text{GHz}$	3~6GHz
1.3max	1.4max

Dimensions (Unit: mm)

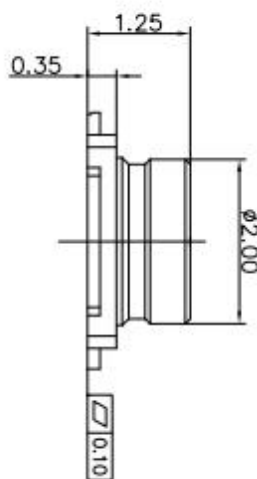
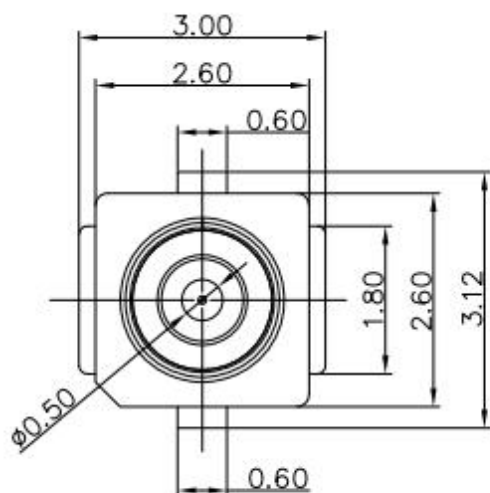

Tolerance: $\pm 0.15\text{mm}$

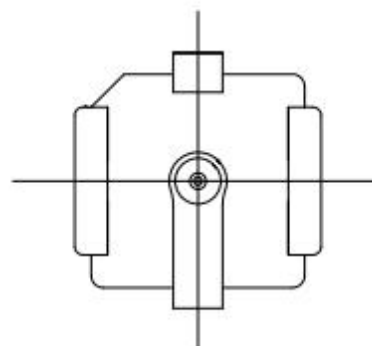

PCB dimensions (Unit: mm)

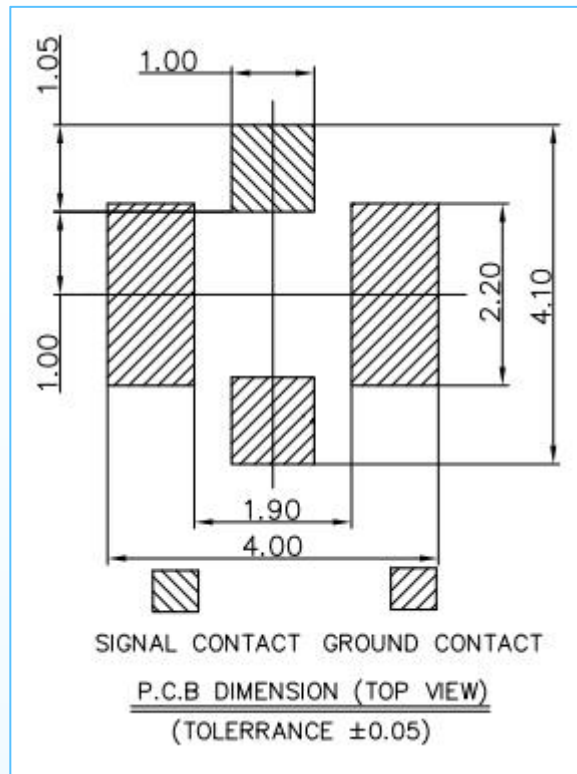

Reflow soldering condition:

